

NOTES

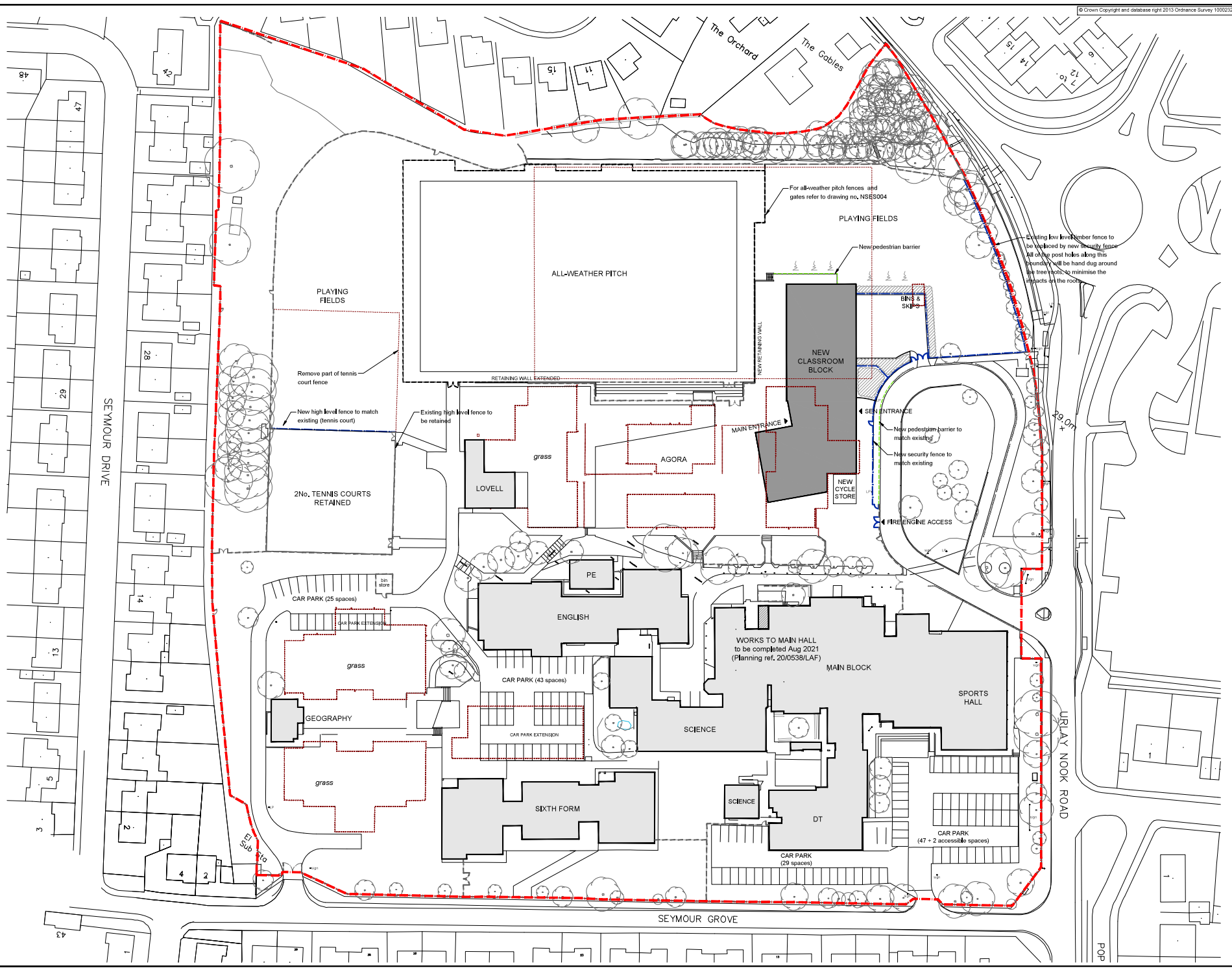

- KEY:**
- Site boundary
 - Existing school buildings to be retained
 - Proposed new three-storey block
 - Buildings to be demolished
 - Existing fences to remain
 - Existing pedestrian barriers to remain
 - Secure line - New fences to match existing
 - New pedestrian barriers to match existing
 - New hedges / shrubs

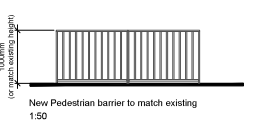
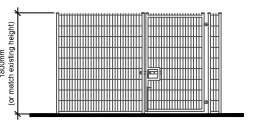

B Palisade fence type changed to weld mesh fence type 19.05.21
 A First issue 19.04.21

Rev	Description	DNr	Chk	Date

Drawing Status: PRELIMINARY APPROVAL
 INFORMATION TENDER CONSTRUCTION

Stockton-on-Tees
BOROUGH COUNCIL

Big plans, bright future

Community Services and Transport
 P.O. Box 220, Wigham Way, Rye, East Sussex, TN22 2YK
 Tel: 01424 350305
 Email: planning@stockton.gov.uk

Project: Egglecliffe School & Sixth Form College Urray Nook Road, Egglecliffe

Content: Proposed Boundary Treatment

Date	Drawn	Checked	Scale	Proj No.	Rev
April 2021	LN	DA	1:500	A10919 / 105	B